

TS-H 木門緩衝暗較

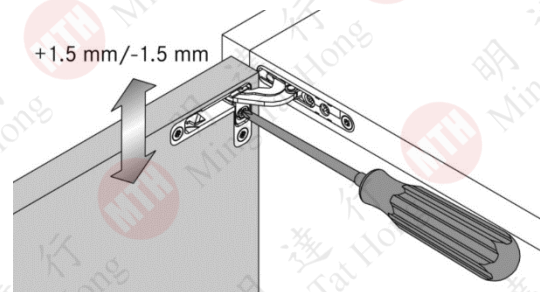
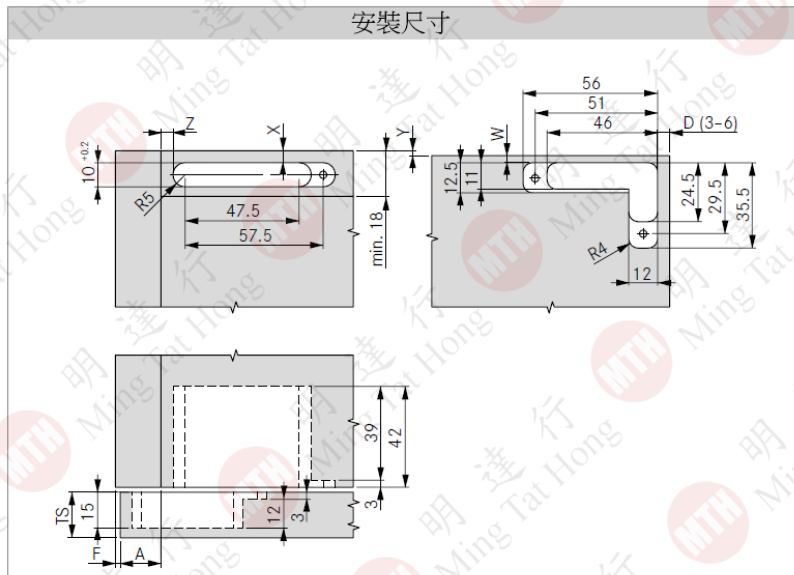
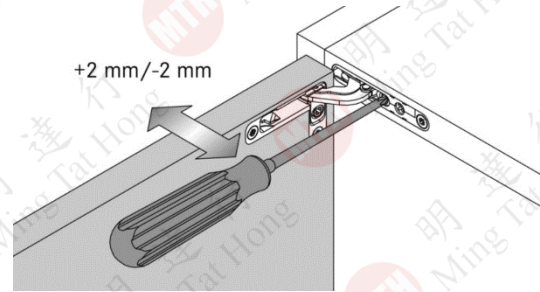
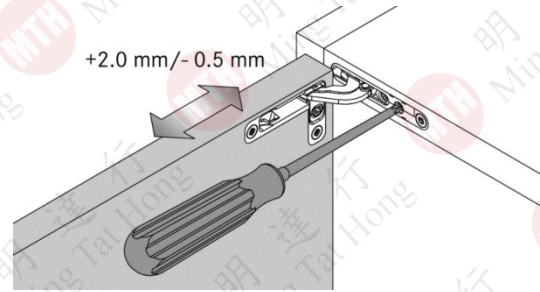
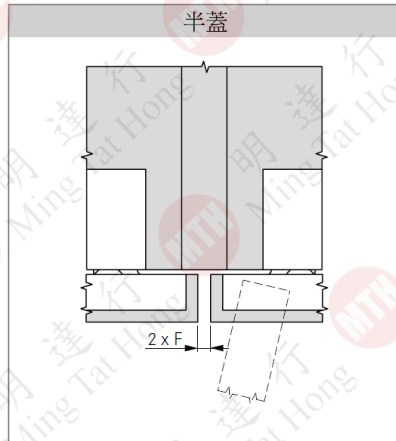
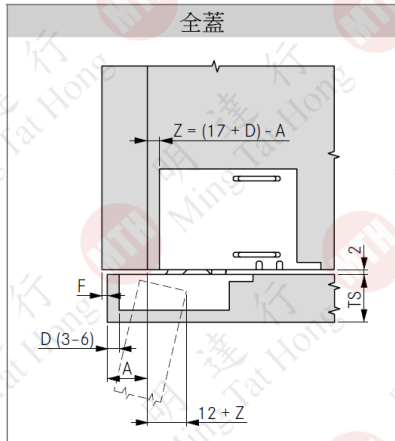

型號
HG63001

MOVEMENT SYSTEMS
G*GRASS®

NEW

2013



全球首創

TIOMOS 天魔師門較
內置調節快慢緩衝器



SOFT-CLOSE INSIDE
DAMPING SYSTEM



reddot design award
honourable mention 2010

TIOMOS Hinge Systems
天魔師內置可調節緩衝門較

110° Hinge 門厚24mm

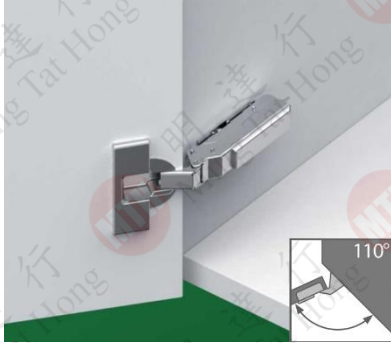

- Opening angle 開啟角度: 110°
- Door thickness 門厚: 24mm
- Convenient depth adjustment 深度可調節
- 3-dimensional adjustment mounting plate 三維調節可配合底座

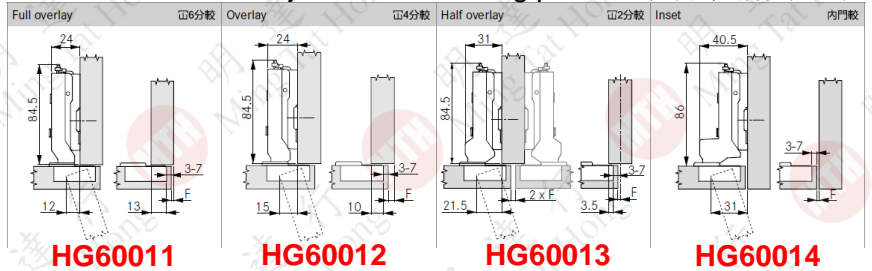

160° Hinge 門厚28mm

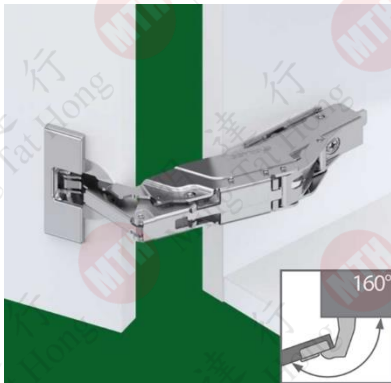

- Opening angle 開啟角度: 160°
- Door thickness 門厚: 28mm
- Convenient depth adjustment 深度可調節
- 3-dimensional adjustment mounting plate 三維調節可配合底座

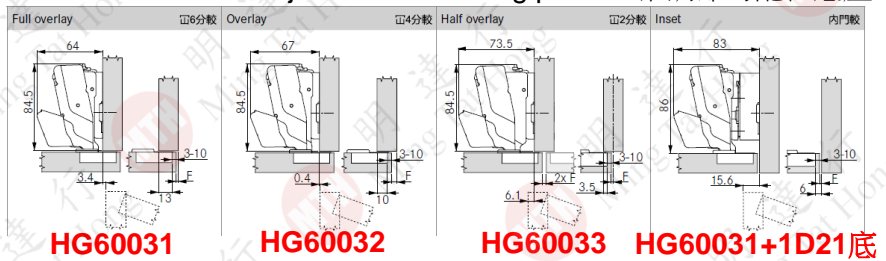

95° Hinge 門厚28mm

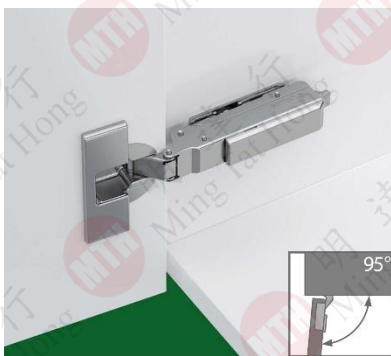

- Opening angle 開啟角度: 95°
- Door thickness 門厚: 28mm
- Convenient depth adjustment 深度可調節
- 3-dimensional adjustment mounting plate 三維調節可配合底座

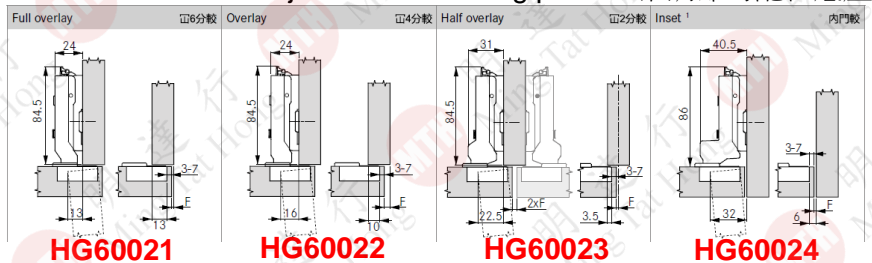

TOOL-FREE DAMPER ADJUSTMENT

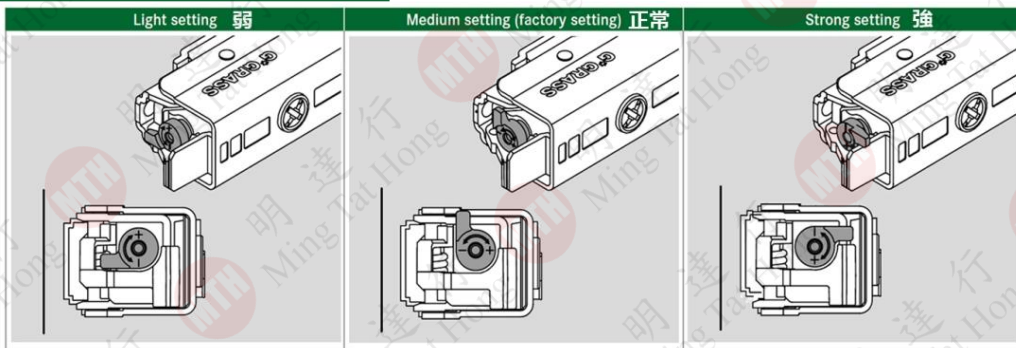



TIOMOS 天魔師

全球首創 內置可調節緩衝器

型號	貨品名稱	可用板厚(mm)	圖片
F028138519	110度 6分較	24	
F028138521	110度 2分較	24	
F028138522	110度 內門較	24	
F028138567	95度 6分較	36	
F028138569	95度 2分較	36	
F028138570	95度 內門較	36	
F028138561	160度 6分較	28	
F028138563	160度 2分較	28	



reddot design award
honourable mention 2010

170° 門較

Nexis Click-on 65 170° wide-angle hinge.



- Opening angle 開啟角度: 170°
- Soft-close compatible
- Door thickness 門厚: 26mm
- With shallow cup depth (11mm) also suitable for soft-formed doors
- Zero protrusion when door opened 90°
- Finger protrusion
- Self-closing
- 3-dimensional adjustment with suitable

Full overlay

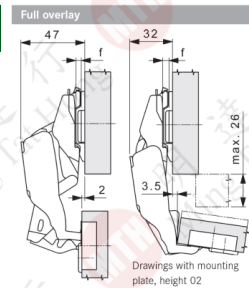
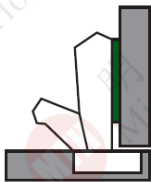

Half overlay

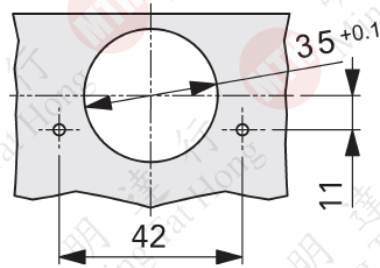
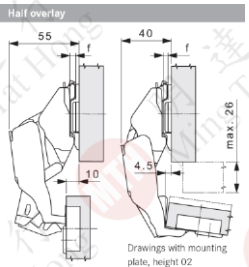
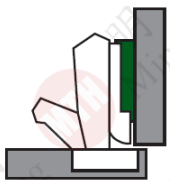

型號

HG1012+02底 2分

HG1011+03底 4分

HG1011+02底 6分

HG1012+08底 內門

Soft-close 170°

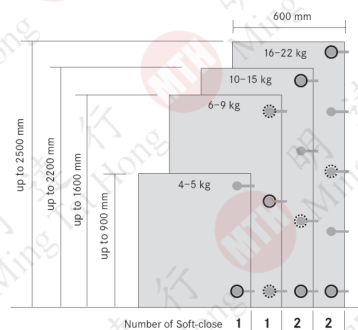
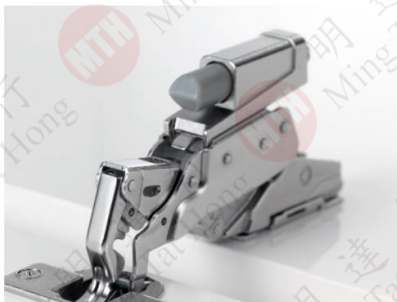

Recommended position for Soft-close 170°



Position for additional Soft-close 170° (where required)

型號

HG9002

貨品名稱

緩衝器

110° 門較

Nexis Click-on 22

110° hinge for standard doors.



- Opening angle 開啟角度: 110°
- Soft-close compatible
- With shallow cup depth (11mm) also suitable for soft-formed doors
- Self-closing
- 3-dimensional adjustment with suitable mounting plate

Full overlay

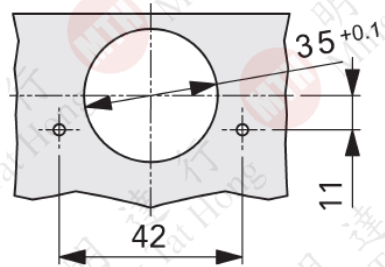
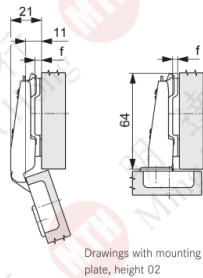
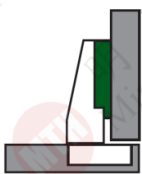

Half overlay

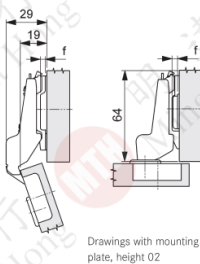
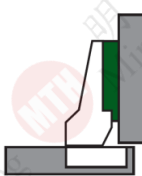

型號
HG1002+02底 2分
HG1001+03底 4分
HG1001+02底 6分
HG1002+08底 內門

Soft-close Click-on

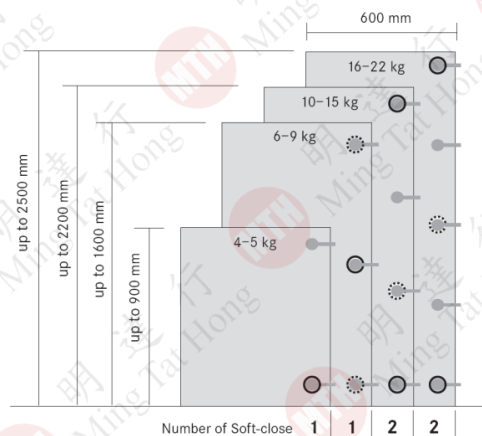

型號	貨品名稱
HG9001	緩衝器

95° 厚門較

Grass Nexis
95° profile doors hinge.



- Opening angle 開啟角度: 95°
- Swift assembly hinge
- Nexis Sialo compatible
- Optimized reveal values with door thicknesses of up to 30mm
- With automatic closing mechanism (springs)
- 3-dimensional adjustment with matching baseplate

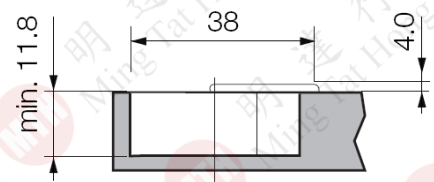
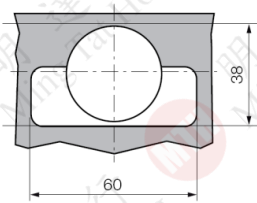
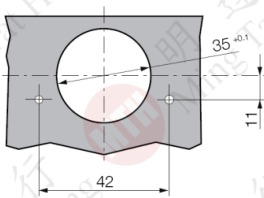

Corner stop

Centre stop

Inset stop

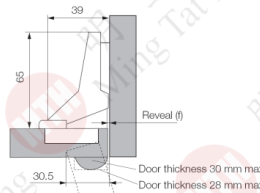
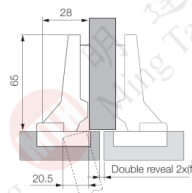
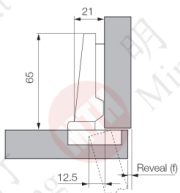

Diagram showing baseplate height h = 0 mm

Diagram showing baseplate height h = 0 mm

Diagram showing baseplate height h = 3 mm

Cup spacing in mm		3	4	5	6
Door stop in mm	19				0
	18		0		
	17		0	2	2
	16	0	2	3	
	15	2	3	4	
	14	2	3	4	
	13	3	4		
12	4				
Baseplate height (h)					

Cup spacing in mm		3	4	5	6
Door stop in mm	11				0
	10			0	
	9		0	2	2
	8	0	2	3	
	7	2	3	4	
	6	2	3	4	
	5	3	4		
4	4				
Baseplate height (h)					

Cup spacing in mm		3	4	5	6
Door reveal (f)	0				
	1	2	3	4	
	2	3	4		
Baseplate height (h)					

型號
HG70125 NX66 直較
HG70126 NX67 曲較
HG70127 NX68 內門較



Door thickness in mm	Cup spacing in mm			
	3	4	5	6
16	0.1	0.1	0.1	0.1
18	0.2	0.2	0.2	0.2
19	0.3	0.3	0.3	0.3
20	0.4	0.4	0.4	0.4
22	0.7	0.7	0.7	0.7
24	1.0	1.0	1.0	1.0
26	1.4	1.4	1.4	1.4
28	1.9	1.9	1.9	1.9
30	3.8	2.9	3.6	2.5
Minimum reveal (f)				

型號	貨品名稱
HG70192	NX00方緩衝器

角位門較

Nexis Click-on 29/ -45

-45° angle corner cabinet hinge, half overlay.



- Opening angle 開啟角度: 125°
- For 45° negative angle 125°
- Self-closing
- 3-dimensional adjustment with suitable mounting plate

Drilling pattern	Item No.
48/9	146.429.53.4515
42/11	138.429.73.4515

Half overlay

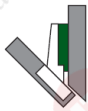

Cup hinge: steel, nickel-plated
Hinge arm: Zamak, nickel-plated

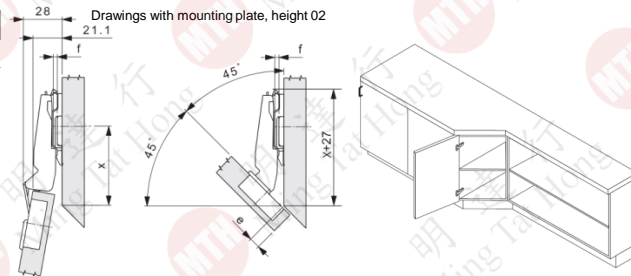

型號
HG3002

135度斜角較

Nexis Click-on 05/45/3

+45° angle corner cabinet hinge, inset.



- Opening angle 開啟角度: 95°
- For 45° angle corner cabinets
- Optimum gap requirements
- Door thickness 門厚: 30mm
- Soft-close compatible
- Self-closing
- 3-dimensional adjustment with suitable mounting plate

Drilling pattern	Item No.
48/9	146.405.53.0315
42/11	138.405.73.0315

Inset



Cup hinge: steel, nickel-plated
Hinge arm: Zamak, nickel-plated

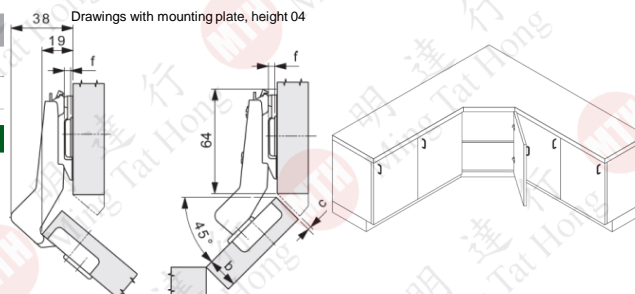

型號
HG3001

角位平門較

Nexis Click-on 05/90/4

95° blind corner hinge, inset.



- Opening angle 開啟角度: 95°
- For direct mounting on protruding post
- Optimum gap requirements
- Door thickness 門厚: 30mm
- Soft-close compatible
- Self-closing
- 3-dimensional adjustment with suitable

Drilling pattern	Item No.
48/9	146.405.53.9615
42/11	138.405.73.9615

Inset

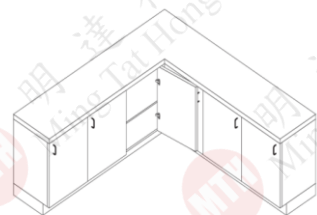
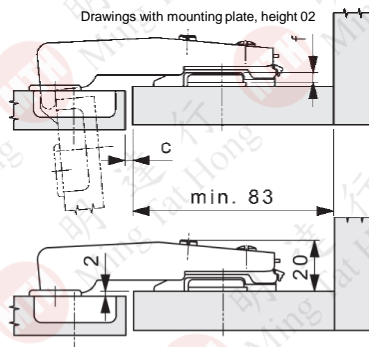
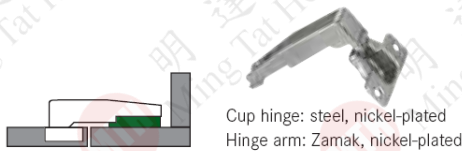

型號

HG3003

NX21 270度角較

Nexis Click-on 00

Folding door hinge with full cup recess for corner fitting.



Drilling pattern	Item No.
42/11	70139-10

- For connecting two corner cabinet doors
- For door thicknesses max. 24mm, factory setting for 19mm door thickness with cup distance 3.5mm
- Shallow cup depth of 10.8mm
- Self-closing
- 3-dimensional adjustment with suitable mounting plate

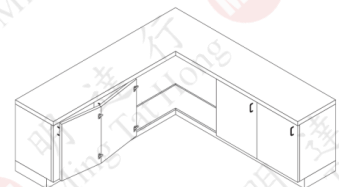
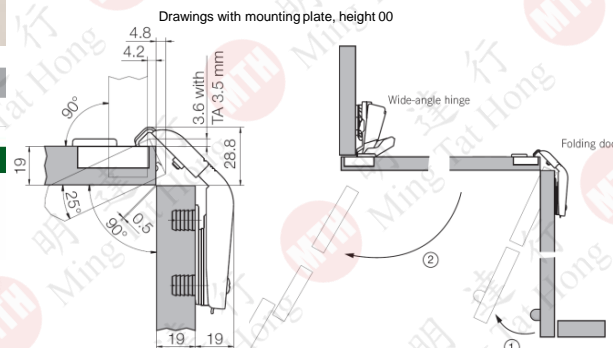
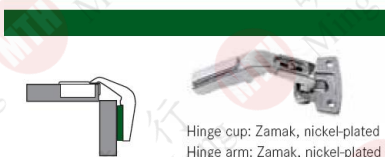

型號

HG70139

128° 玻璃門較

Grass Nexis

95° profile doors hinge.



Stainless steel adapter



Soft-close 170° set



- Opening angle 開啟角度: 128°
- Soft-close compatible
- Installation by gluing a stainless steel adapter onto the door
- The hinge is connected to the adapter via an eccentric cam
- Quick final mounting without having to drill the glass
- Nexis Sialo compatible
- Self-closing
- 3-dimensional adjustment with suitable matching plate

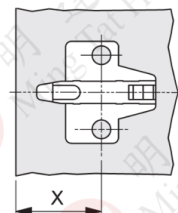
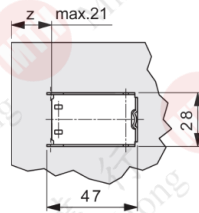
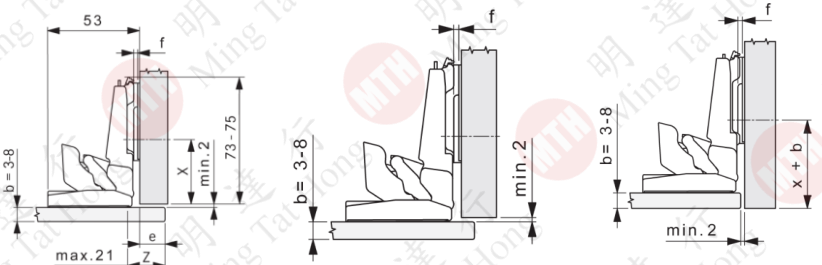

$z = \text{overlay } e + 9 \text{ mm}$
with mounting plate (f), height 02

$X = 37 \text{ mm}$ with mounting plate for
Line boring 28 mm

$X = 46 - 48 \text{ mm}$ with mounting plate
for Line boring 37 mm



Important!
Mirro hinges must not be used with mounting plates that have eccentric cams.

Number of Mirro hinges

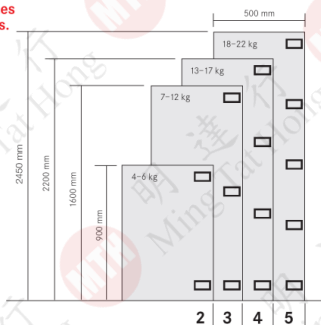

型號	貨品名稱
HG2001	門較+底板+底片+膠紙
HG9021	玻璃較緩衝器

Note on installation

We recommend that you contact your glass / door supplier regarding the selection and application of the adhesive for fastening the hinge adapter onto mirror and glass doors.

Liability disclaimer

Please note that Grass cannot accept any liability for the type of adhesive and the bonding method used or any consequential damages resulting from these.

鋁框門, 木門內藏緩衝器



Soft-close AL

Fitting dimensions

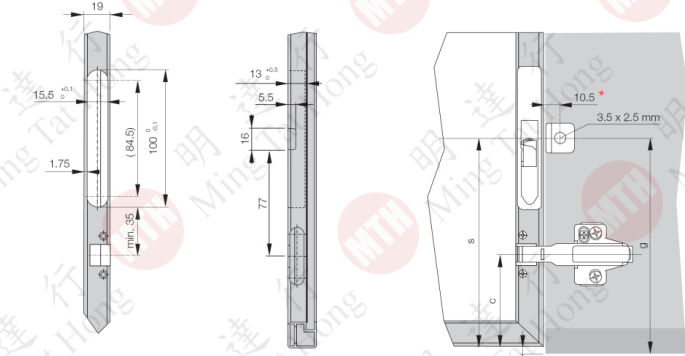

Fitting dimensions

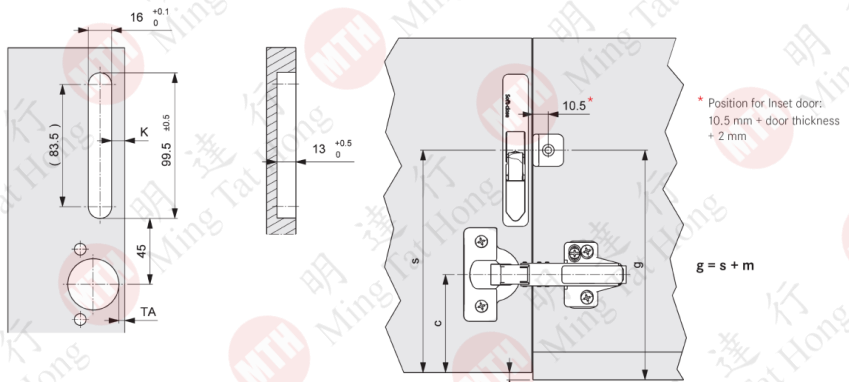

Universal counterpart



Installation

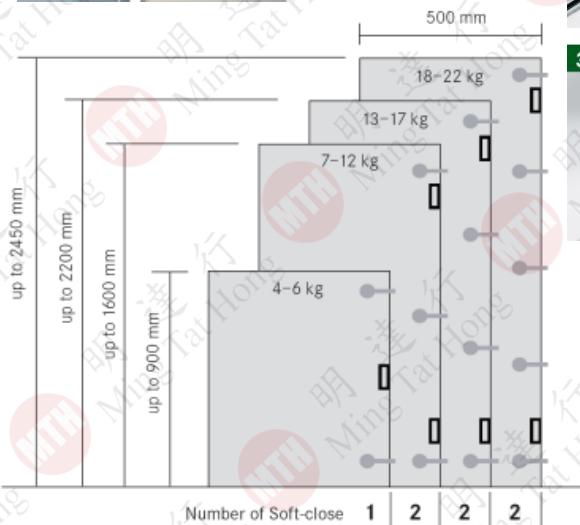
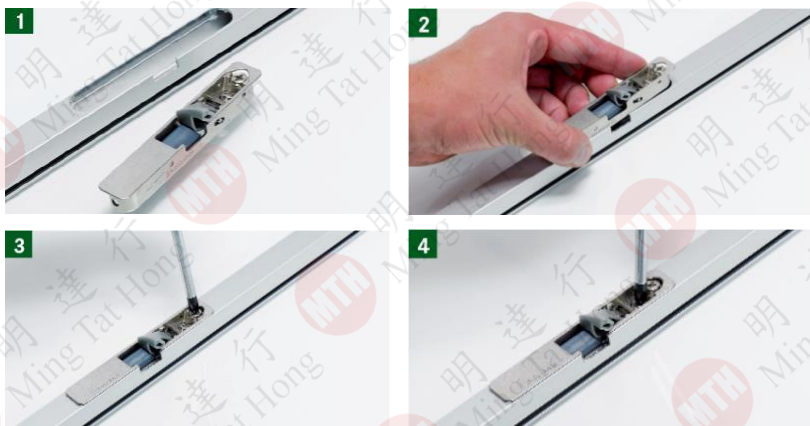

型號

HG9011

Recommended position for Soft-close AL

Soft-close pin

Air damper for door with Nexis and Snap on 3000 hinges.



- Suitable for all door shapes, sizes and materials(wood and aluminum frames and glass doors)
- Suitable for upgrading
- Forb drill hole mounting or for fitting with adapter plate

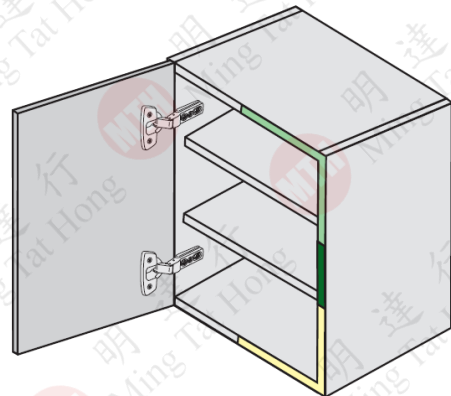

For larger doors we recommend the installation of an additional damper.

緩衝氣制

十字底座

一字底座

Soft-close pin

Frame adapter plate

Linear adapter plate

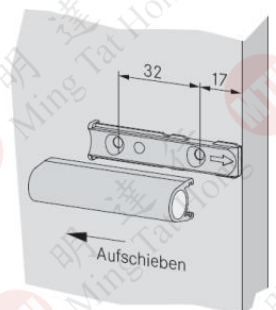
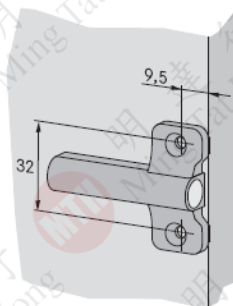
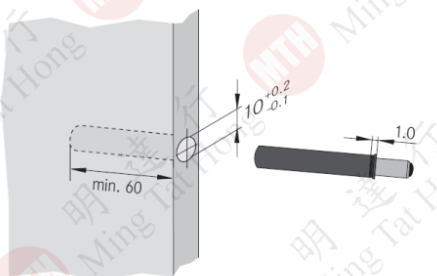
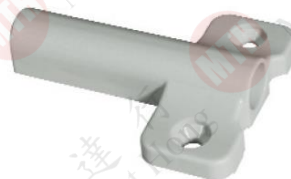

型號

SN66528

型號

SN63311

型號

SN63309

強力襟彈門磁制

Tipmatic

For handle-free wooden doors and aluminum frame doors.



- Gently tapping the front causes the doors to open to a convenient angle
- Any hinges without closing mechanism can be used
- Large magnet catch range-closes door reliably
- Gap adjustment from 2.5mm to 5.5mm with integrated, self-locking and toolless depth adjustment feature
- Mounting on the front side of the cabinet or with an adapter plate

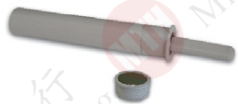

- Incl. magnet, Ø 15 x 8 mm (hole edge cover 1 mm)
- Hole drilled from the front
- Plastic RAL 7036, platinum grey



Front gap adjustment with integrated "toolless depth adjustment" feature

The front gap can be adjusted with the Tipmatic drawer.

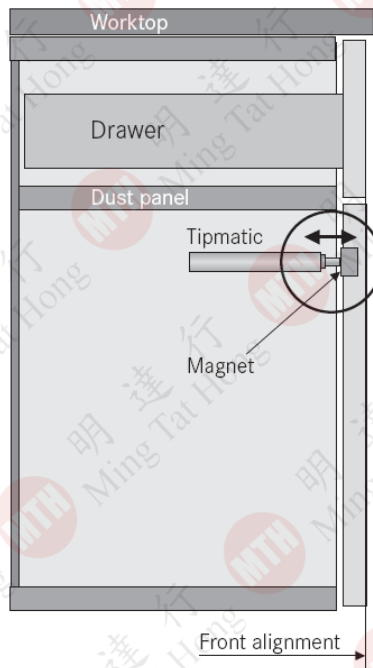
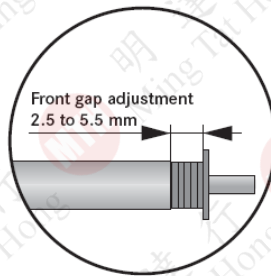
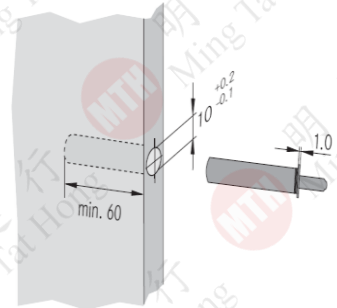

型號
SN68873

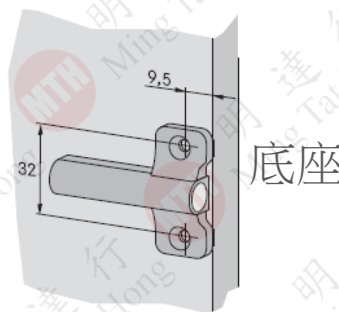

型號
SN63311

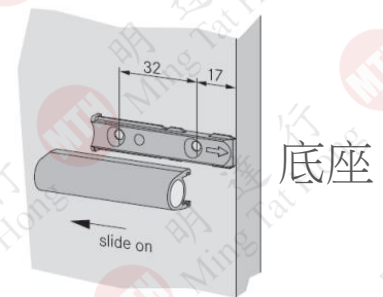

型號
SN63309

110° 重裝門較

Snap On 3000

110° hinge for standard doors.

Snap On mounting plates

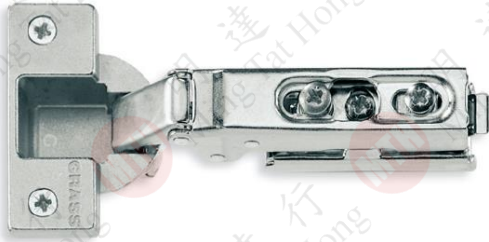

- Opening angle 開啟角度: 110°
- Door thickness 門厚: 24mm
- With and without self-closing
- Hinge arm with integrated 3-dimensional adjustment

Full overlay

Typ 3703

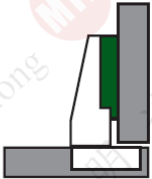

Full overlay

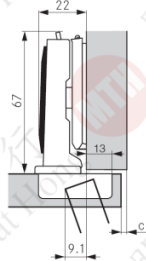

Drawing with mounting plate, height 1.3

Cup distance

	3	4	5	6	7	
20					1.3	
19				1.3		
18			1.3			
17		1.3		4.3		
16	1.3			4.3		
15			4.3			
14		4.4				
13	4.3					
12				9.3		

Door overlay max. Mounting plate height (f)

Safety test

A defined large additional load is imposed on the door which has to endure a certain number of opening and closing movements. (300 N)



Half overlay

Typ 3704

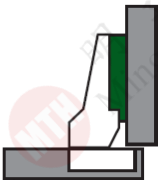

Half overlay

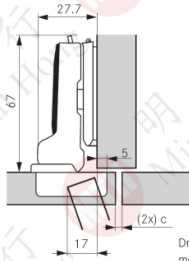

Drawing with mounting plate, height 1.3

Cup distance

	3	4	5	6	7	
11				1.3		
10			1.3			
9		1.3		4.3		
8	1.3			4.3		
7			4.3			
6		4.3				
5	4.3					
4				9.3		

Door overlay max. Mounting plate height (f)

Wear test / durability test

A defined additional load is imposed on the door which has to endure a certain number of opening and closing movements. (100,000 cycles with additional load 2 x 20 N)

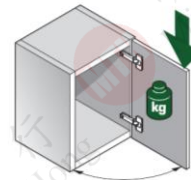

max. opening angle minus 5°

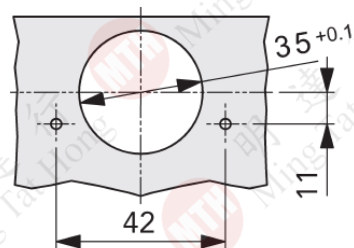
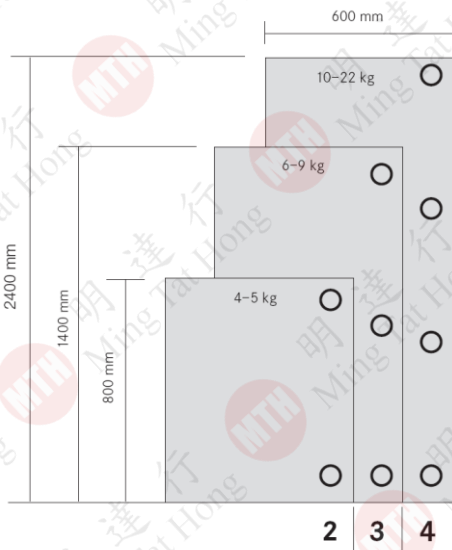

型號	貨品名稱	蓋口
HG0113	110度有制 3704+1.3底	二分
HG0112	110度有制 3703+4.3底	四分
HG0112	110度有制 3703+1.3底	六分
HG0113	110度有制 3704+9.3底	內門

110° 重裝無制門較

Snap On 3000

110° hinge for standard doors.

Snap On mounting plates



- Opening angle 開啟角度: 110°
- Door thickness 門厚: 24mm
- With and without self-closing
- Hinge arm with integrated 3-dimensional adjustment

Full overlay

Typ 3713

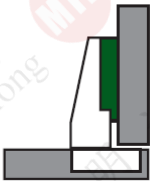

Full overlay

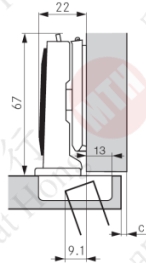

Drawing with mounting plate, height 1.3

Cup distance

	3	4	5	6	7	
20					1.3	
19				1.3		
18			1.3			
17		1.3		4.3		
16	1.3			4.3		
15		4.3				
14		4.4				
13	4.3					
12				9.3		

Door overlay max.

Mounting plate height (f)

Safety test

A defined large additional load is imposed on the door which has to endure a certain number of opening and closing movements. (300 N)



Half overlay

Typ 3714

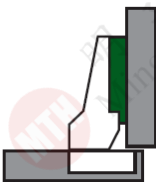

Half overlay

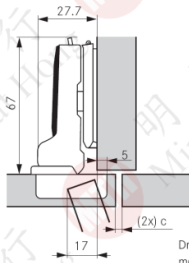

Drawing with mounting plate, height 1.3

Cup distance

	3	4	5	6	7	
11				1.3		
10			1.3			
9		1.3		4.3		
8	1.3			4.3		
7		4.3				
6		4.3				
5	4.3					
4				9.3		

Door overlay max.

Mounting plate height (f)

Wear test / durability test

A defined additional load is imposed on the door which has to endure a certain number of opening and closing movements. (100,000 cycles with additional load 2 x 20 N)



max. opening angle minus 5°

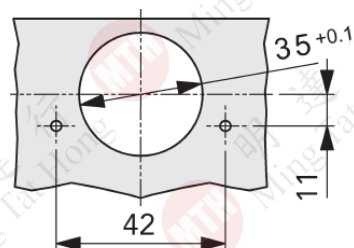
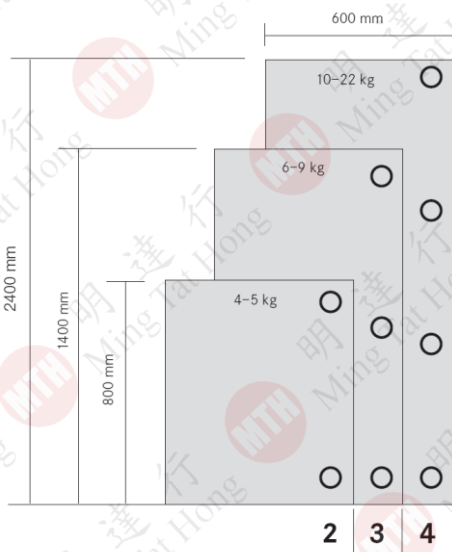

型號	貨品名稱	蓋口
HG3714	110度無制 3714+1.3底	二分
HG3713	110度無制 3713+4.3底	四分
HG3713	110度無制 3713+1.3底	六分
HG3714	110度無制 3714+9.3底	內門

165° 重裝門較

Snap On 3000 165° wide-angle hinge.

Snap On mounting plates



- Opening angle 開啟角度: 165°
- Door thickness 門厚: 22mm
- Zero protrusion when door opened 90° using full overlay hinge
- Min. reveal 0mm up to 22mm door thickness
- With and without self-closing
- Hinge arm with integrated 3-dimensional adjustment

Full overlay

Typ 3903

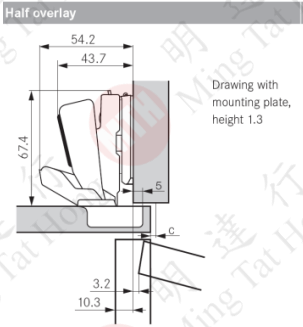
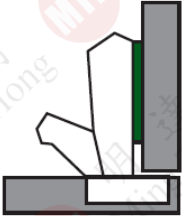

Door overlay max.	Cup distance									
	3	4	5	6	7	8	9	10		
23								1.3		
22								1.3		
21								1.3		
20						1.3		4.3		
19					1.3			4.3		
18			1.3			4.3		4.3		
17		1.3				4.3				
16	1.3				4.3					
15		4.3						9.3		
14			4.3					9.3		
13	4.3								Mounting plate height (f)	

Safety test

A defined large additional load is imposed on the door which has to endure a certain number of opening and closing movements. (300 N)



Half overlay

Typ 3904

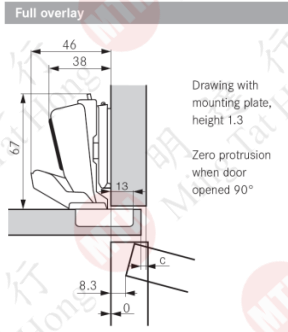
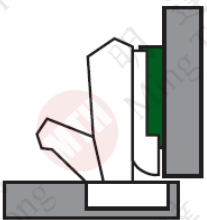

Door overlay max.	Cup distance									
	3	4	5	6	7	8	9	10		
13							1.3			
12						1.3		4.3		
11					1.3			4.3		
10					1.3			4.3		
9			1.3			4.3				
8		1.3				4.3				
7			4.3					9.3		
6		4.3						9.3		
5	4.3							9.3		
									Mounting plate height (f)	

Wear test / durability test

A defined additional load is imposed on the door which has to endure a certain number of opening and closing movements. (100,000 cycles with additional load 2 x 20 N)

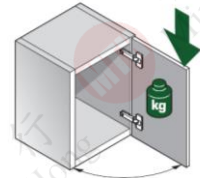

max. opening angle minus 5°

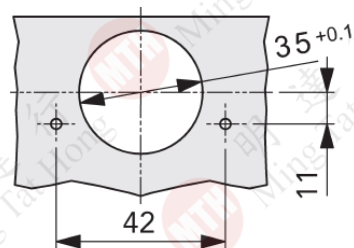
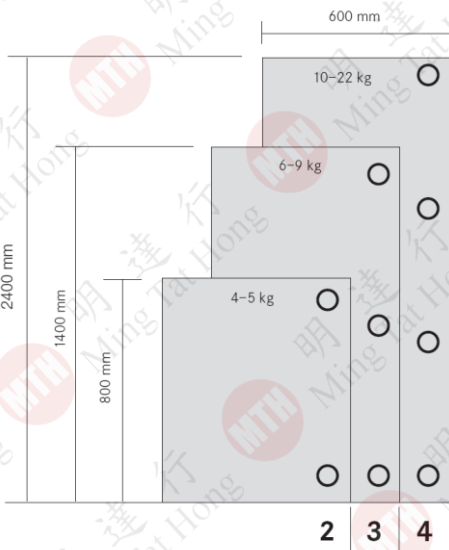

型號	貨品名稱	蓋口
HG0132	165度有制 3904+1.3底	二分
HG0131	165度有制 3903+4.3底	四分
HG0131	165度有制 3903+1.3底	六分
HG0132	165度有制 3904+9.3底	內門

165° 重裝無制門較

Snap On 3000 165° wide-angle hinge.

Snap On mounting plates



- Opening angle 開啟角度: 165°
- Door thickness 門厚: 22mm
- Zero protrusion when door opened 90° using full overlay hinge
- Min. reveal 0mm up to 22mm door thickness
- With and without self-closing
- Hinge arm with integrated 3-dimensional adjustment

Full overlay

Typ 3913

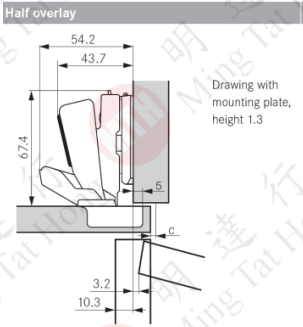
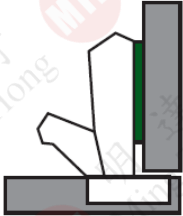

Door overlay max.	Cup distance									
	3	4	5	6	7	8	9	10		
23								1.3		
22								1.3		
21								1.3		
20						1.3		4.3		
19					1.3			4.3		
18			1.3			4.3		4.3		
17		1.3				4.3				
16	1.3				4.3					
15		4.3						9.3		
14			4.3					9.3		
13	4.3								Mounting plate height (f)	

Safety test

A defined large additional load is imposed on the door which has to endure a certain number of opening and closing movements. (300 N)



Half overlay

Typ 3914

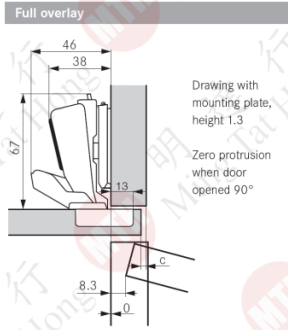
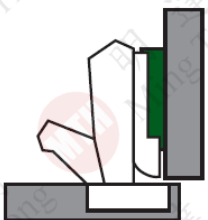

Door overlay max.	Cup distance									
	3	4	5	6	7	8	9	10		
13							1.3			
12						1.3		4.3		
11					1.3			4.3		
10			1.3					4.3		
9		1.3				4.3				
8	1.3					4.3				
7			4.3					9.3		
6		4.3						9.3		
5	4.3							9.3		
									Mounting plate height (f)	

Wear test / durability test

A defined additional load is imposed on the door which has to endure a certain number of opening and closing movements. (100,000 cycles with additional load 2 x 20 N)

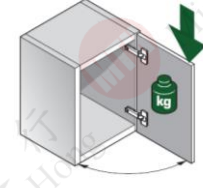

max. opening angle minus 5°

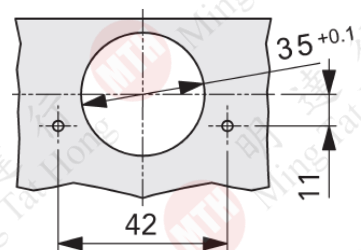
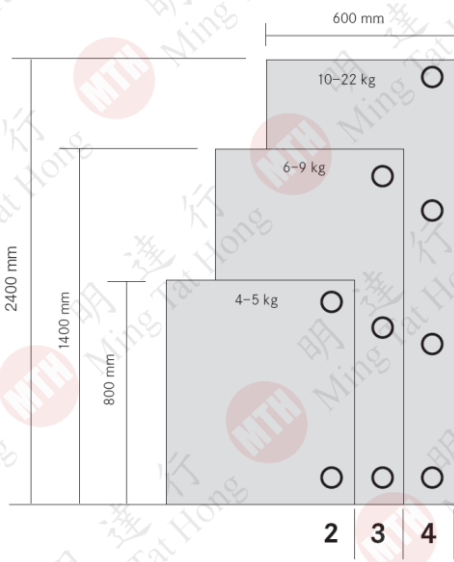

型號	貨品名稱	蓋口
HG3914	165度無制 3914+1.3底	二分
HG3913	165度無制 3913+4.3底	四分
HG3913	165度無制 3913+1.3底	六分
HG3914	165度無制 3914+9.3底	內門

G100 ECO

Hinge type G173/ G174
Slide On -110° Standard hinge.

Slide-on system

With the time-tested technology, the hinge arm simply slides onto the fitted baseplate and is then fixed in position. This method is used on the G100 hinge.

In the case, the hinge arm is positioned on the baseplate and then just snapped in place.

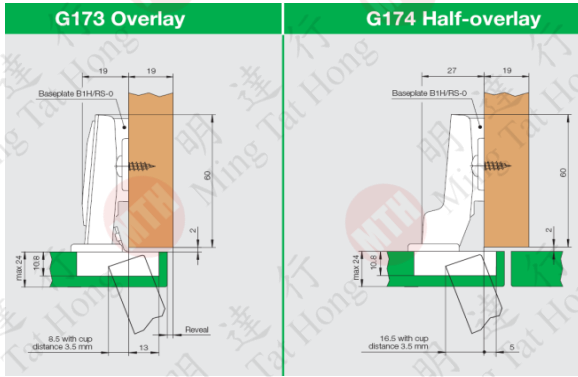
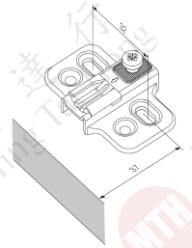

型號	貨品名稱	蓋口
HG0106	110度有制 174+1.3底	二分
HG0107	110度有制 173+4.3底	四分
HG0107	110度有制 173+1.3底	六分
HG0106	110度有制 174+9.3底	內門

Hinge type G193/ G194

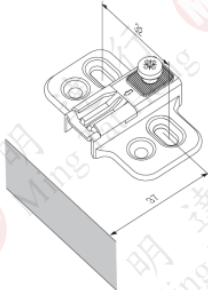

The 135° reduction clip is used to limit the angle on the G193/ G194 hinge to 135°.

Technical information

Bore diameter 35 mm ± 0.1
Bore depth min. 10.8 mm

max. door thickness (with door corner radius of 1 mm) 22 mm
max. cup drilling distance 10 mm
min. reveal 0.5 mm
Up to 20 mm door thickness a minimum reveal generally 0 mm on hinge side possible.

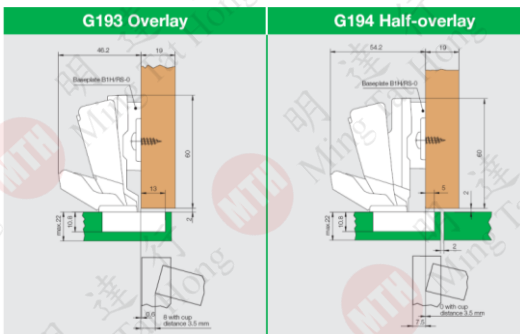

型號	貨品名稱	蓋口
HG0176	165度有制 194+1.3底	二分
HG0175	165度有制 193+4.3底	四分
HG0175	165度有制 193+1.3底	六分
HG0176	165度有制 194+9.3底	內門

